

# INSTALLATION AND SERVICE MANUAL

**LIGMAN**  
NORTH AMERICA

For Installation of Lador Cluster Column Projectors LED.  
Model. ULD-20002-US02-TS1-US2409010

## PRODUCT DRAWING (DIMENSIONS)

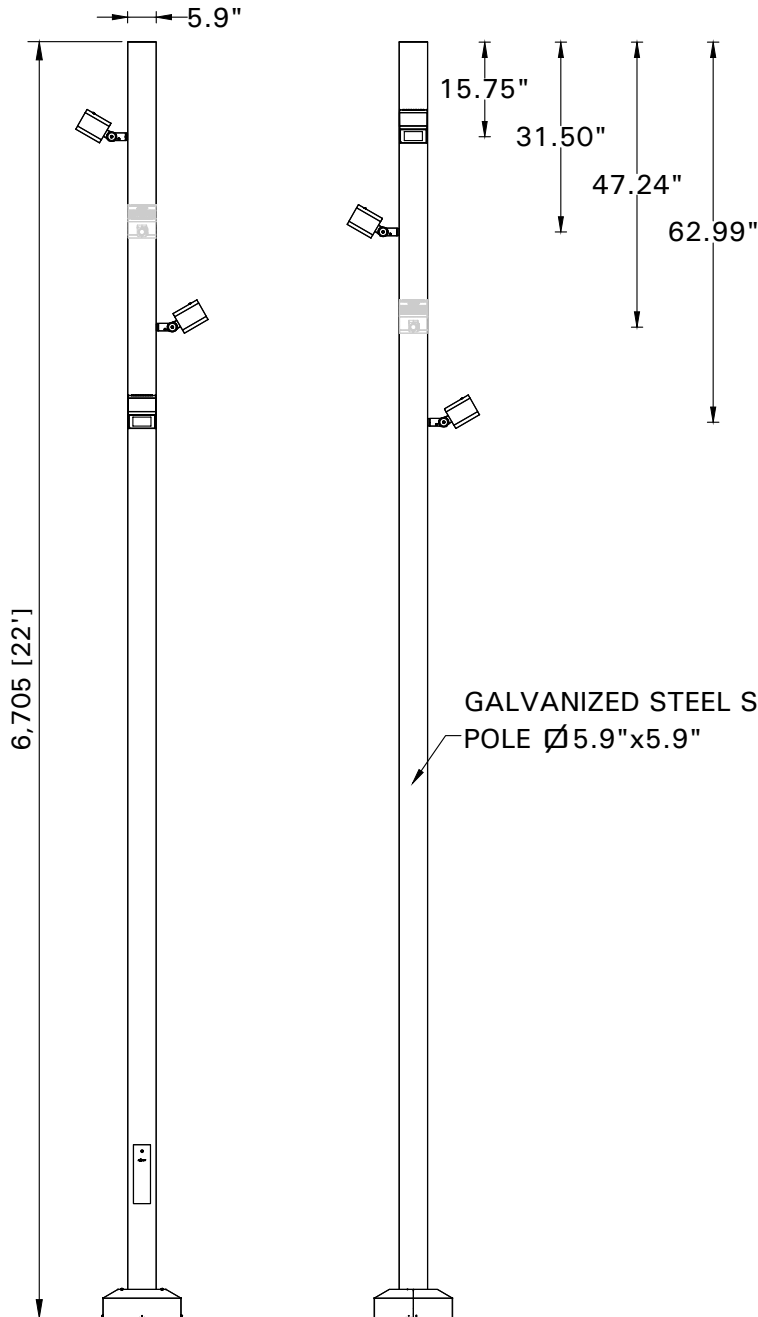

## SUITABLE FOR WET LOCATIONS

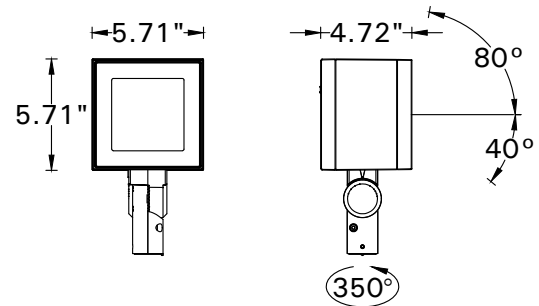

ULD-20002

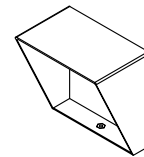

(4)A53131  
ANTI GLARE VISOR

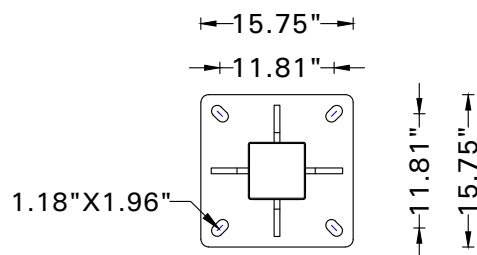
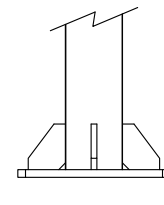

MOUNTING DETAIL

### Notice to installer :

**1.WIRING INSTRUCTIONS** Warning : RISK OF FIRE AND ELECTRICAL SHOCK. : FIXTURE MUST BE INSTALLED BY A QUALIFIED ELECTRICIAN ONLY>FIXTURE IS INTENDED FOR INSTALLATION IN ACCORDANCE WITH THE NATIONAL ELECTRICAL CODE, LOCAL AND FEDERAL CODE SPECIFICATIONS. DISCONNECT POWER BEFORE SERVICING.

**Ligman Lighting USA**

7144 NE Progress Court, Hillsboro  
Oregon, 97124, USA  
Tel : 503 645 0500 | Fax : 503 645 8100

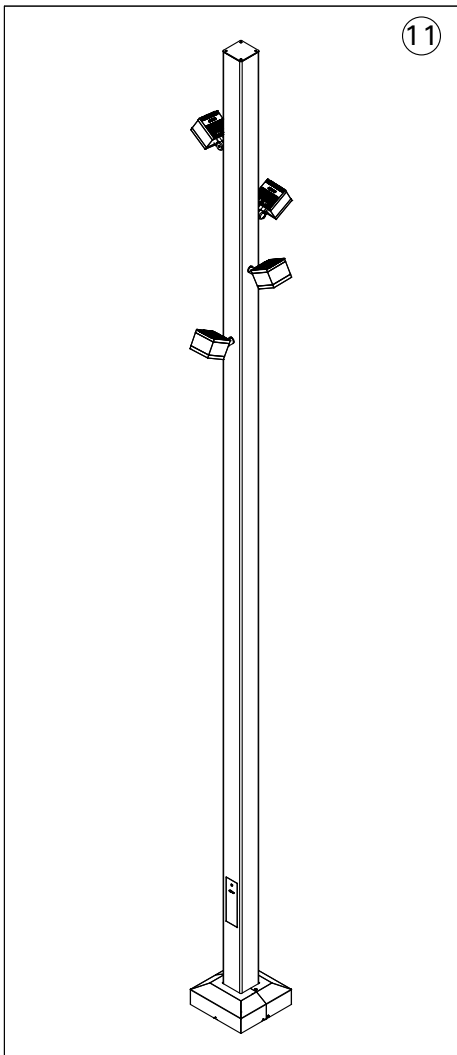
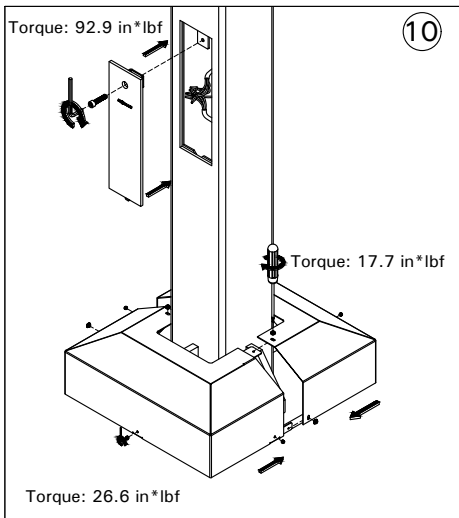
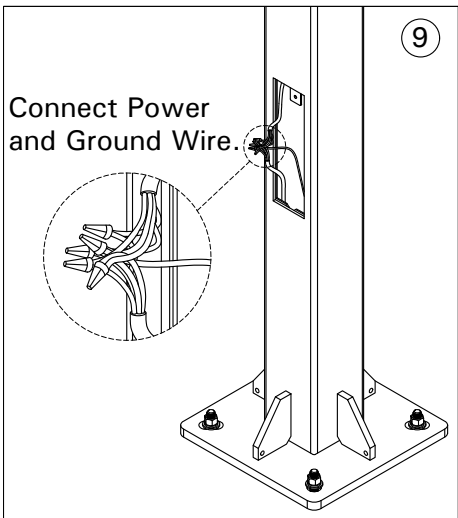
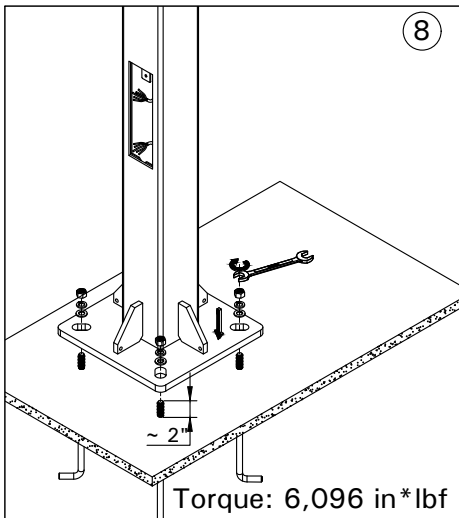
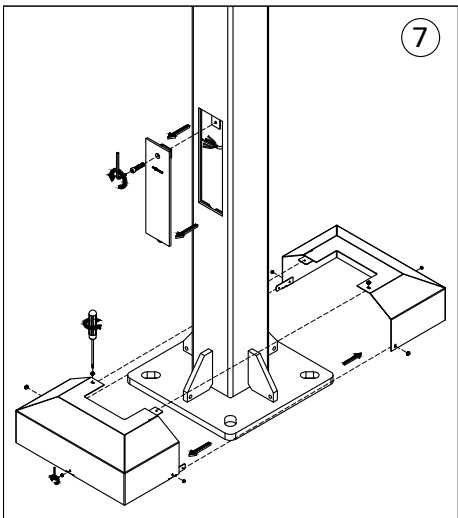
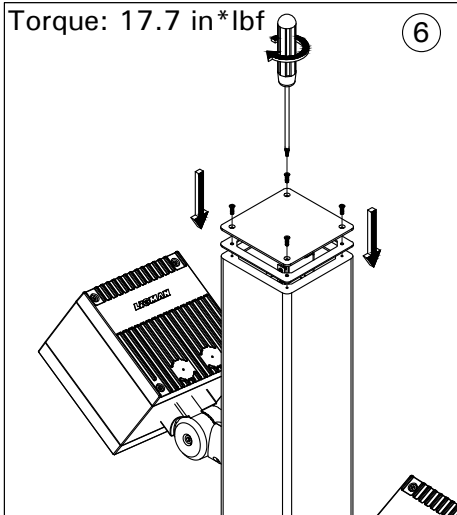
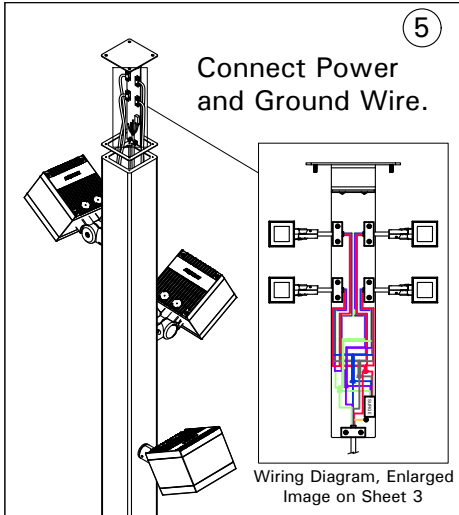
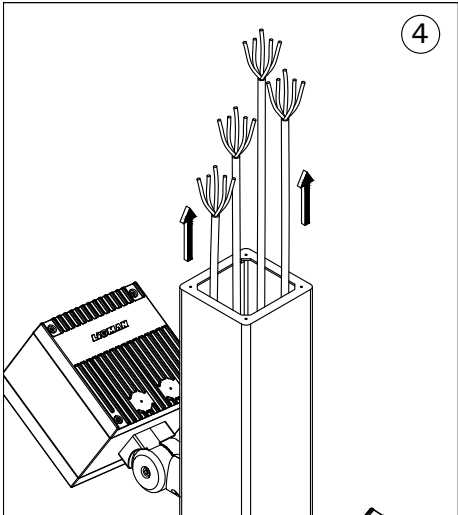
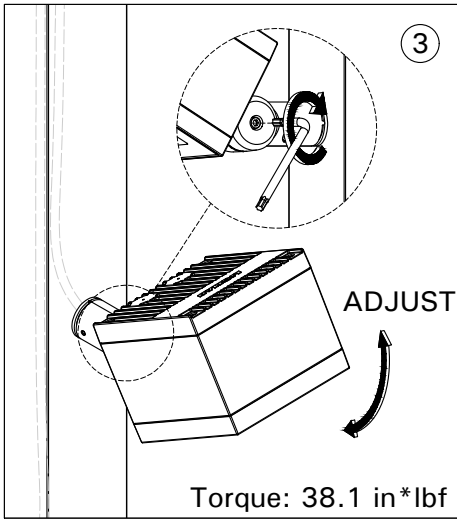
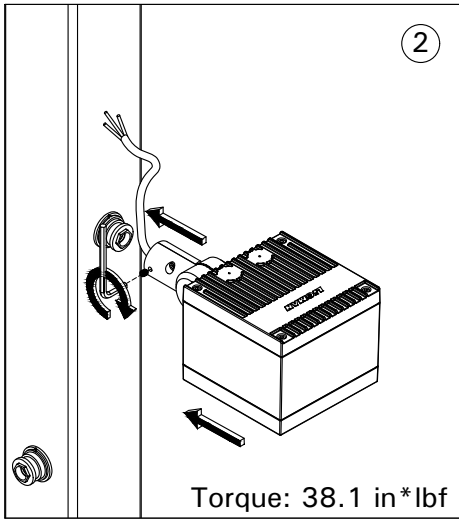
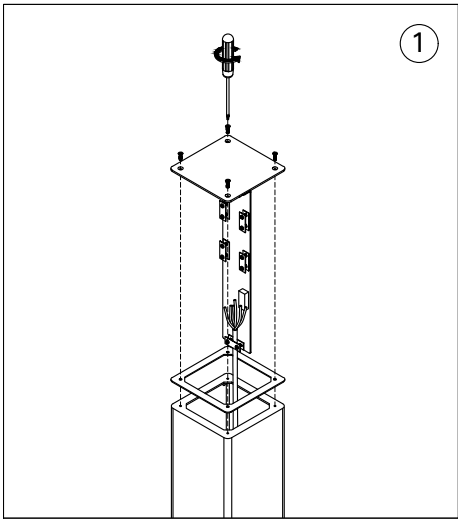

# WIRING DIAGRAM

